

For Sale By Sealed Bid Auction

This entire Lake and Land Could be yours!!! Seller says Auction /Bid it Out!!! for 15 Days Starting July 15,-July 30

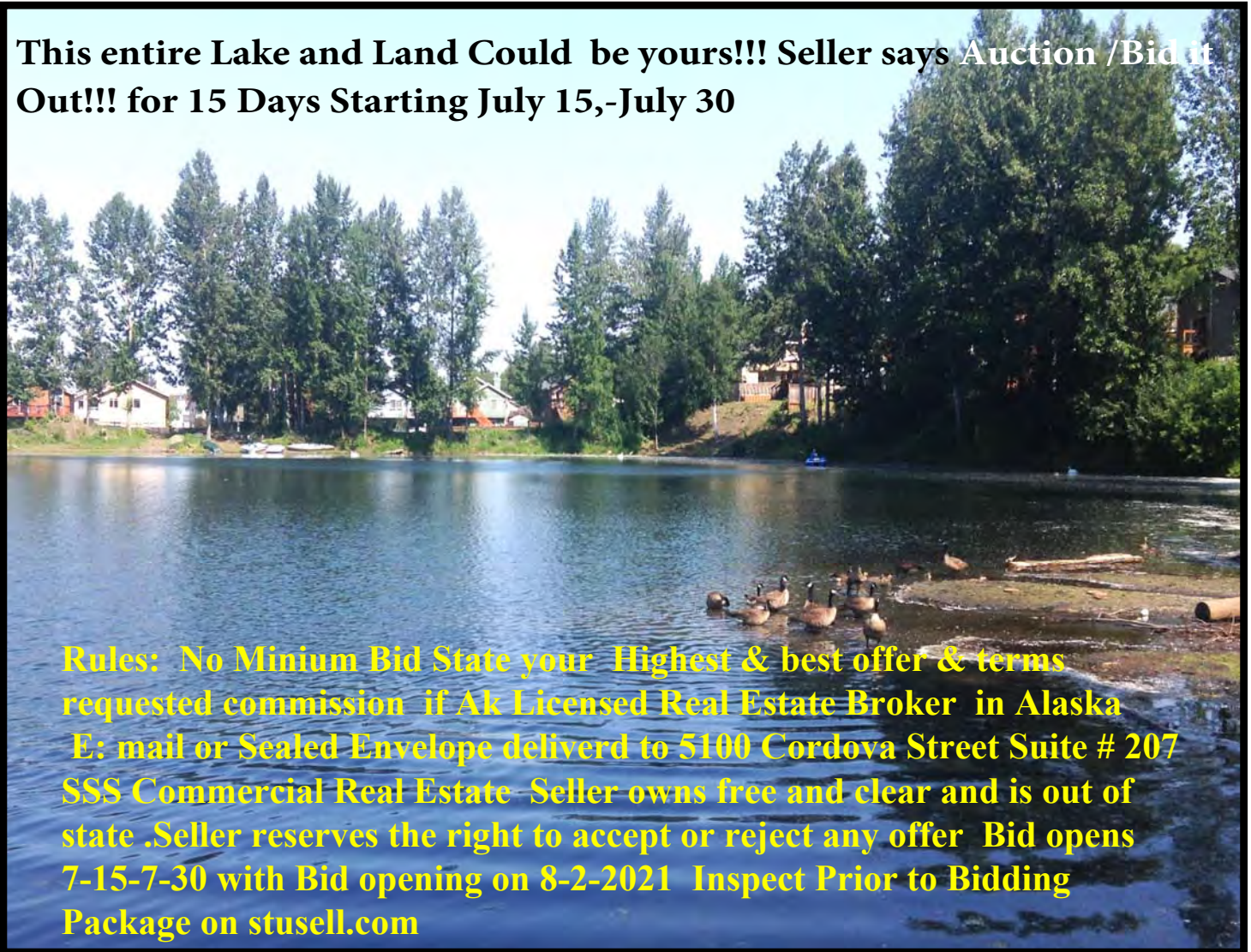

Rules: No Minium Bid State your Highest & best offer & terms requested commission if Ak Licensed Real Estate Broker in Alaska E: mail or Sealed Envelope delivered to 5100 Cordova Street Suite # 207 SSS Commercial Real Estate Seller owns free and clear and is out of state .Seller reserves the right to accept or reject any offer Bid opens 7-15-7-30 with Bid opening on 8-2-2021 Inspect Prior to Bidding Package on stusell.com

EASTLAKE TR C1 (Reflection Lake)

Sale Price: Open Bid

Size: 9.101 Acres

STEWART SMITH

C: (907) 727-8686

Email: Stewart@StuSell.com



WWW.STUSELL.COM

SSS COMMERCIAL REAL ESTATE • 5100 Cardova Street Suite 207 Anchorage, AK 995013

Table of Contents

Disclaimer	3
Information	4
Photographs	5
Location and Aerial Map	6-7
Plat Map	8
Water & Sewer	9-10

STEWART SMITH

C: (907) 727-8686

Email: Stewart@StuSell.com



WWW.STUSELL.COM

SSS COMMERCIAL REAL ESTATE • 5100 Cardova Street Suite 207 Anchorage, AK 995013

Disclaimer

The information contained herein was obtained from the Municipality of Anchorage, Mat-Su Borough and/or other private and governmental sources. This information is not warranted or guaranteed in any way. The owner and Stewart Smith of SSS Commercial Real Estate make no warranties, either expressed or implied, as to the completeness or accuracy of any of the information contained herein. This disclaimer includes, but is not limited to, square footage, land size, lease lengths, business profits, financial profiles, rental income, equipment lists, statements & financial profiles and inventory.

Each interested party should conduct his or her own due diligence investigation. The reader of this package is hereby instructed to verify all information contained herein. The reader is also instructed to seek legal advice as well as accounting advice as to the effects of this transaction.

This property may be subject to prior sale/lease and withdrawal from the market place at any time without notice. This packet is solely the property of Stewart Smith of SSS Commercial Real Estate. Any reproduction without authorization is prohibited, including data storage.

STEWART SMITH

C: (907) 727-8686

Email: Stewart@StuSell.com



WWW.STUSELL.COM

SSS COMMERCIAL REAL ESTATE • 5100 Cordova Street Suite 207 Anchorage, AK 99503

Information

Legal: EASTLAKE TR C1

Sale Price: Open Bid

Size: 396,436 Total SF (9.1 Acres)

Zoning: R2M- Multi Family Residential

Summary: Own This Whole East-side Anchorage Lake ! & Small Island 9.101 Acres and & Land that potentially hold 6-8 Luxury Condominiums Reflection Lake (East lake Tract C1) Price is **Open Bid** Excellent Fishing , Bird Watching , Boating Etc. Vacant Land size is 50,867 Only Woodridge Condominium Association has legal easement to Reflection Lake This open bis will start on July 15,2021 and stay open until July 30, Bids will unsealed on August 2 Place your Name Bid amount , Cash ,terms, requested commission amount if Licensed as Broker in State of Ak send to SSS Commercial 5100 Cordova Street Suite 201 Anchorage Ak by email to sss@stusell.com **Seller reserves to accept or reject any bid offers**

STEWART SMITH

C: (907) 727-8686

Email: Stewart@StuSell.com



WWW.STUSELL.COM

SSS COMMERCIAL REAL ESTATE • 5100 Cordova Street Suite 207 Anchorage, AK 995013

Photographs



STEWART SMITH

C: (907) 727-8686

Email: Stewart@StuSell.com



WWW.STUSELL.COM

SSS COMMERCIAL REAL ESTATE • 5100 Cardova Street Suite 207 Anchorage, AK 995013

Maps

Location Map

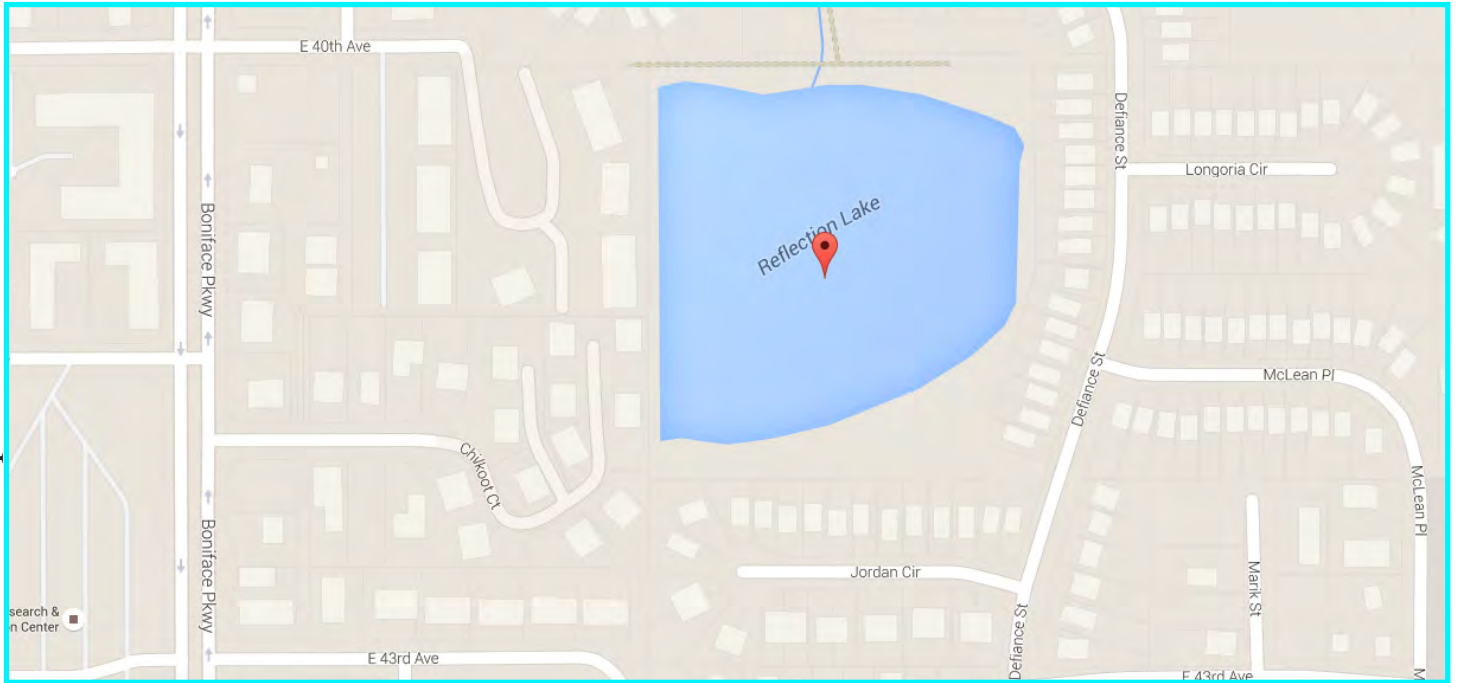

Aerial Map

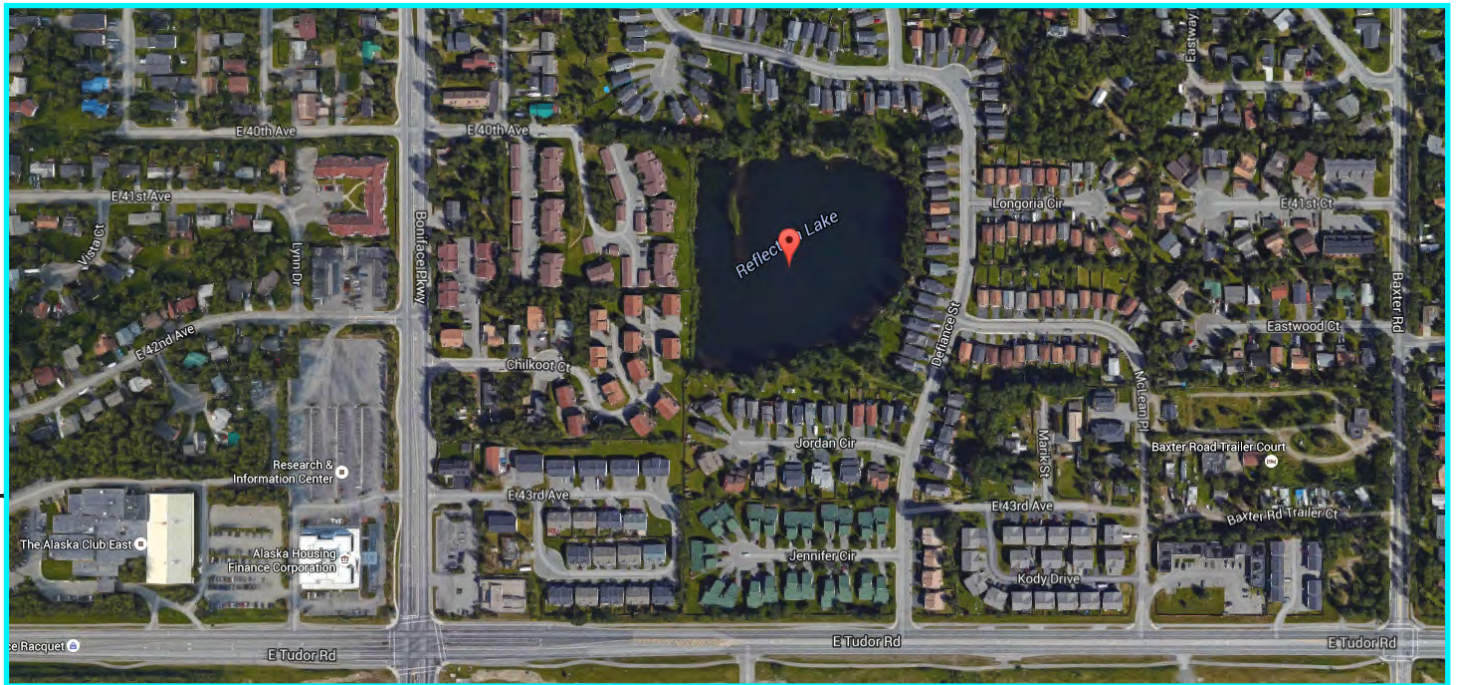

STEWART SMITH

Cell: (907) 727-8686

Email: Stewart@StuSell.com



WWW.STUSELL.COM

SSS COMMERCIAL REAL ESTATE • 5100 Cardova Street Suite 207 Anchorage, AK 995013

Maps



STEWART SMITH

C: (907) 727-8686

Email: Stewart@StuSell.com



WWW.STUSELL.COM

SSS COMMERCIAL REAL ESTATE • 5100 Cardova Street Suite 207 Anchorage, AK 995013

Plat Maps

Lang & Associates, Inc.
Professional Land Surveyors

11500 Daryl Avenue
Anchorage, Alaska 99515-3048
(907) 522-6476
(907) 522-4825 Fax
kglang@alaska.net

REFLECTION POND

Modified April 10th 07 by G Kostal

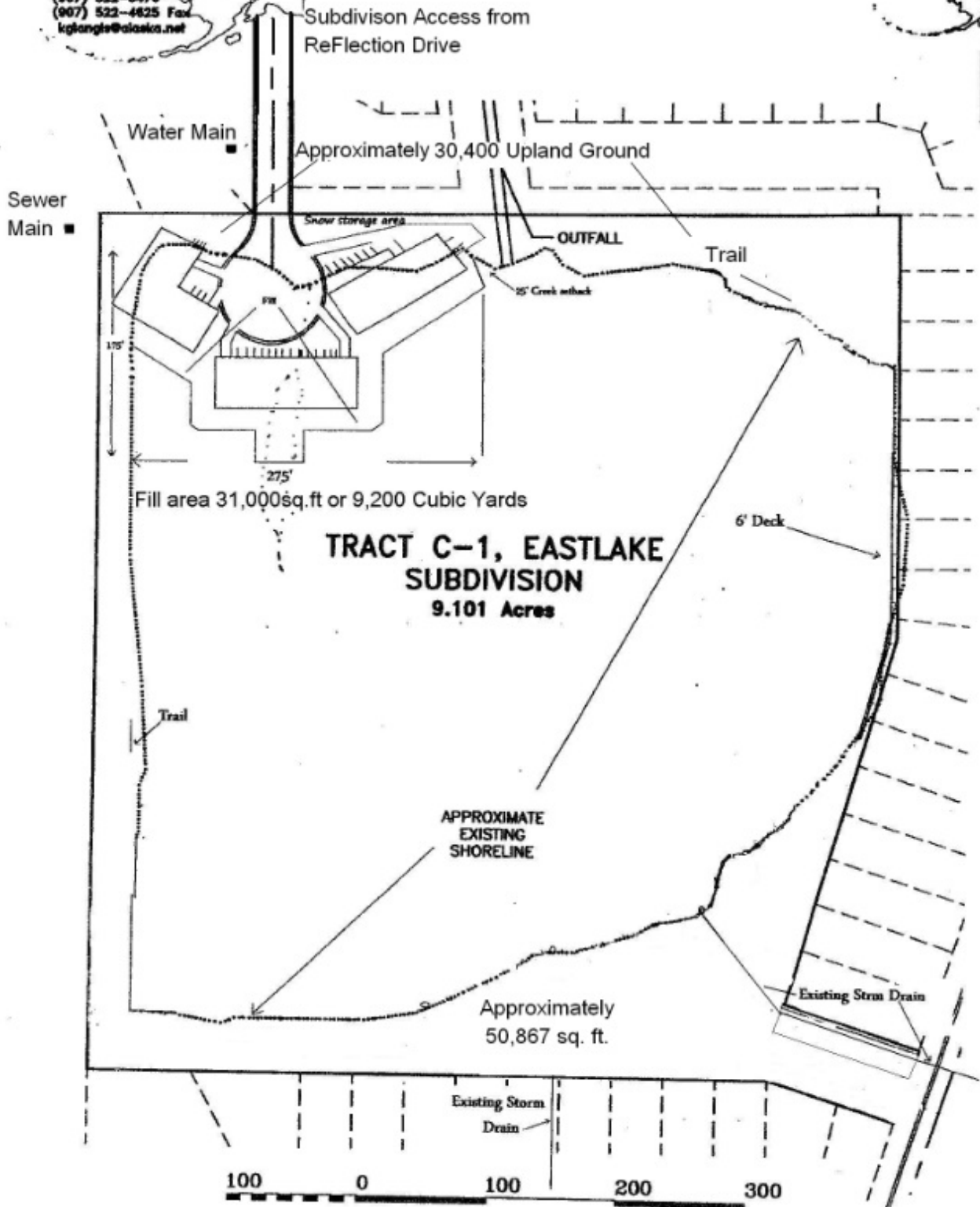

Water Maps



Municipality of Anchorage
Water & Wastewater Utility

Notes:

These scales are accurate only when printed on 11x17 Paper with the Fit To Page option selected

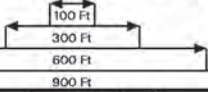

500 Scale Map: 50908
SW 1/4 Sec 26 T13N R3W

Water Distribution System

SW1738

SCALE 1" = 300'
April 2002



STEWART SMITH

C: (907) 727-8686

Email: Stewart@StuSell.com



WWW.STUSELL.COM

SSS COMMERCIAL REAL ESTATE • 5100 Cardova Street Suite 207 Anchorage, AK 99503

Sewer Maps

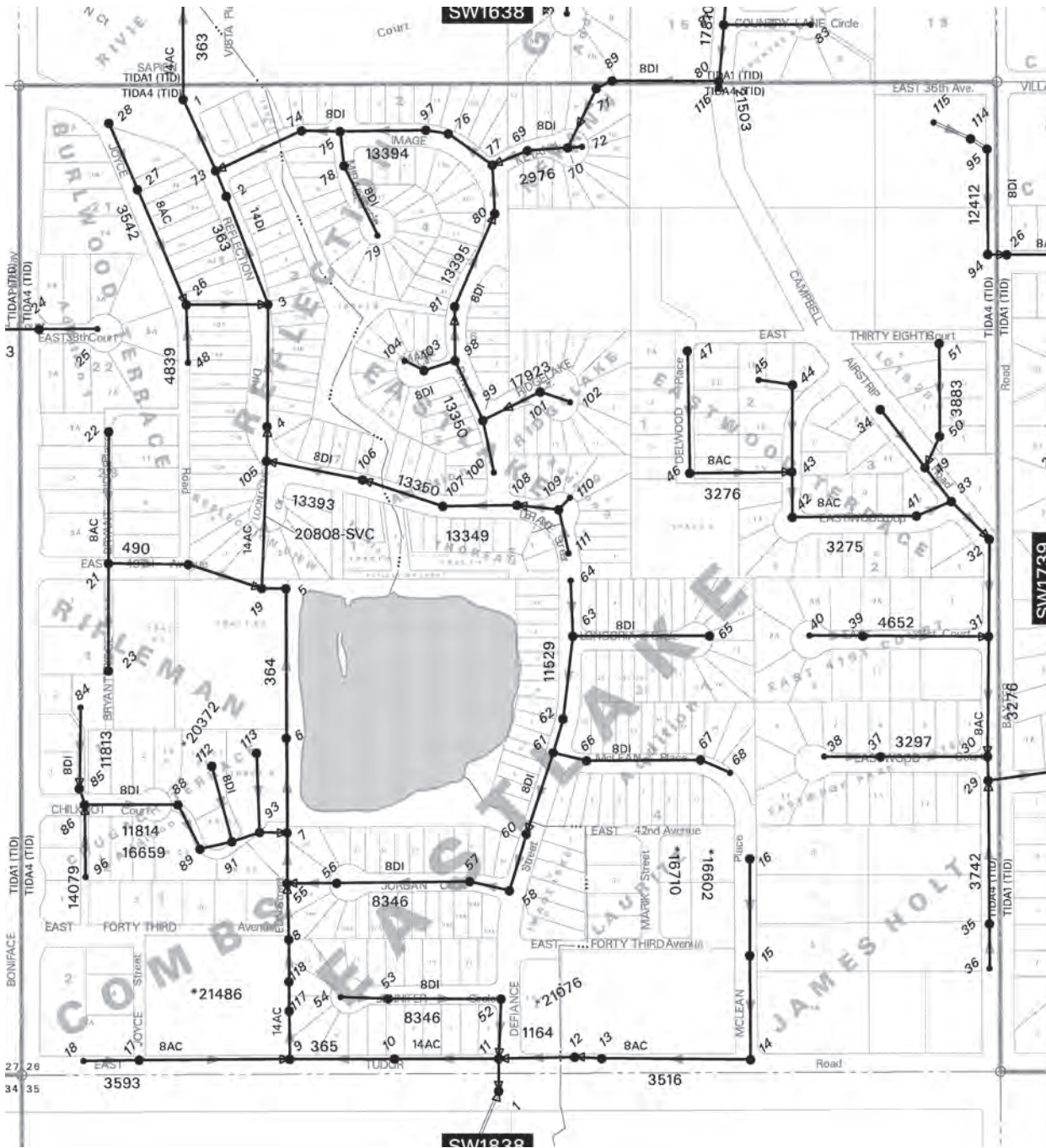

Municipality of Anchorage
Water & Wastewater Utility

Notes:

These scales are accurate only when printed on 11x17 Paper with the Fit To Page option selected

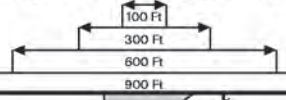

500 Scale Map: 50908
SW 1/4 Sec26 T13N R3W

Wastewater Collection System

SCALE 1" = 300'

April 2002

SW1738

STEWART SMITH

C: (907) 727-8686

Email: Stewart@StuSell.com



WWW.STUSELL.COM

SSS COMMERCIAL REAL ESTATE • 5100 Cardova Street Suite 207 Anchorage, AK 995013